

Wall System

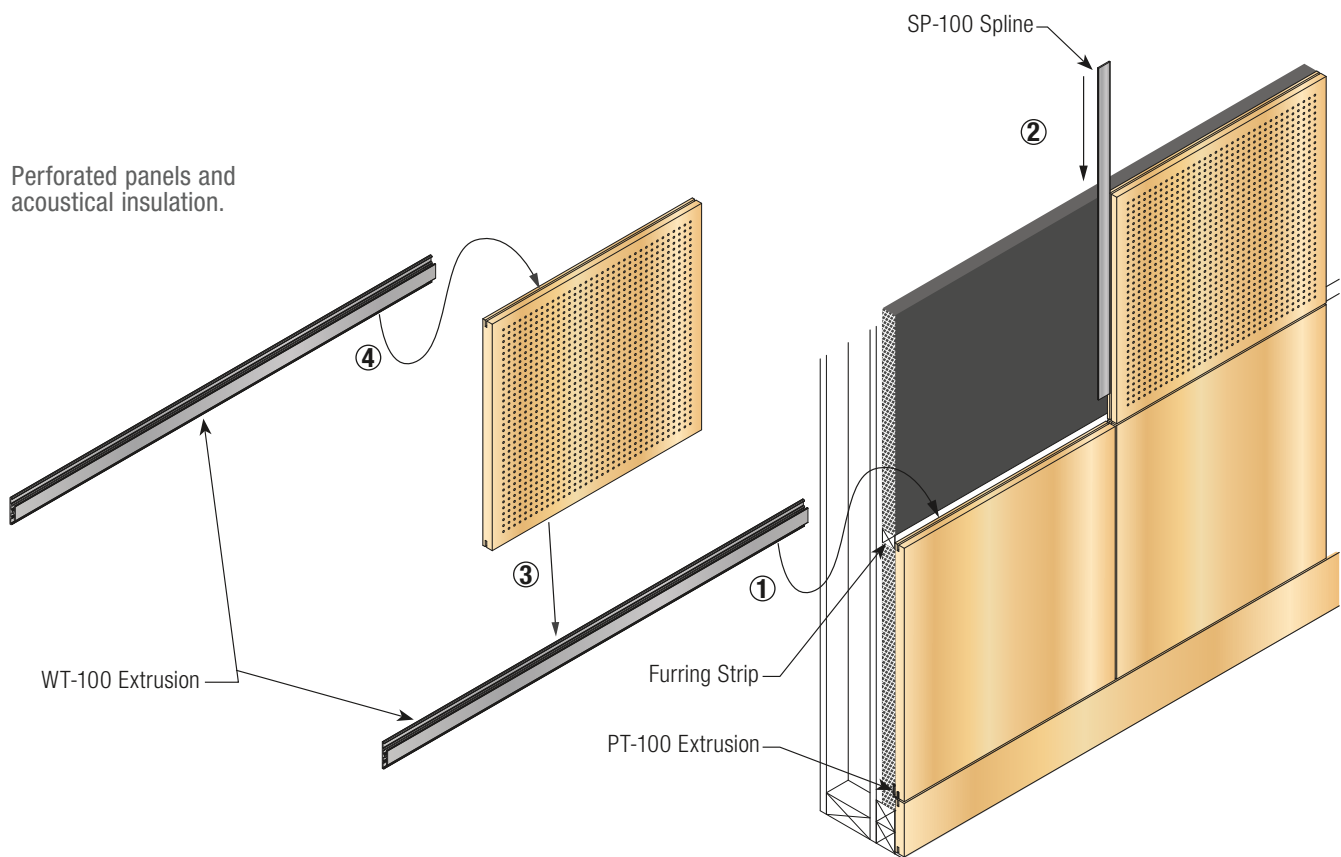

The **WoodWorks Concerto™** Wall System includes the following interchangeable aluminum extrusions with different reveal size options, between 1/8" and 1". The WoodWorks Concerto system is available in solid and micro-perforated, perforated, and Encore™ 6 acoustic panel, and Flat Panel.



CONCERTO™ WALL SYSTEM

The Concerto Wall System is comprised of a combination of separate aluminum extrusions. These consist of wall trim and vertical splines, inside and outside corner trim, and perimeter and base trim. A majority of our extrusions are interchangeable – enabling flexibility in the design of any wall project.

The illustration below shows typical positions and applications of our extrusions, as well as optional designs. A variety of sizes, shapes, and configurations can be easily incorporated (including access columns). Please contact ACGI or your ACGI Sales Representative for custom applications or special project requirements.

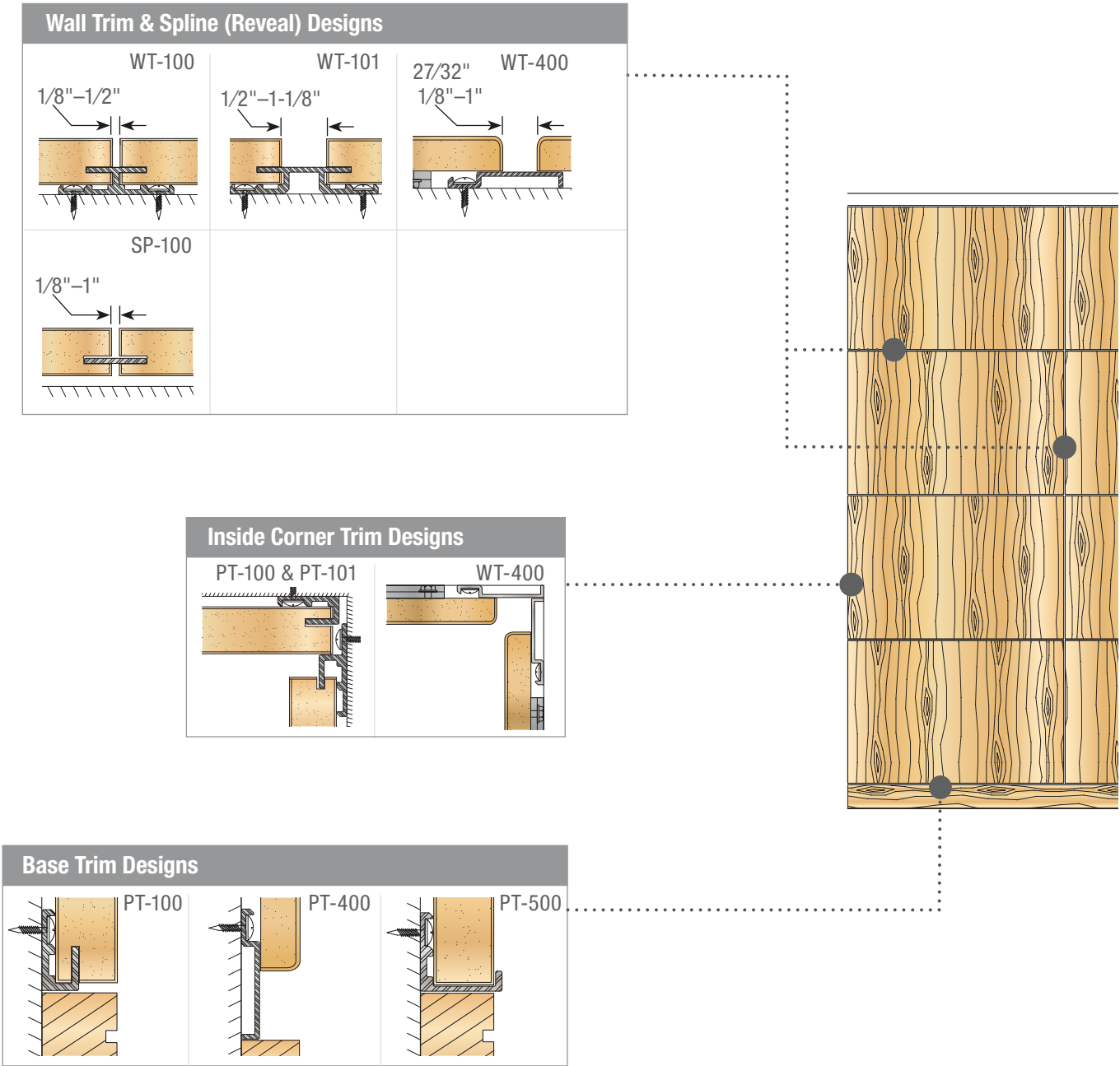

WOODWORKS™ ACGI Concerto™

Wall System

Perimeter Trim Designs

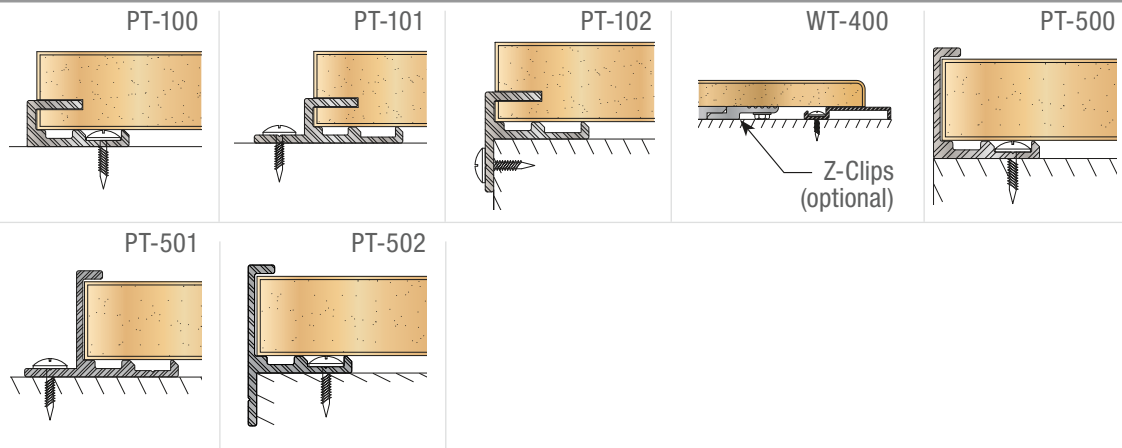

Outside Corner Trim Designs

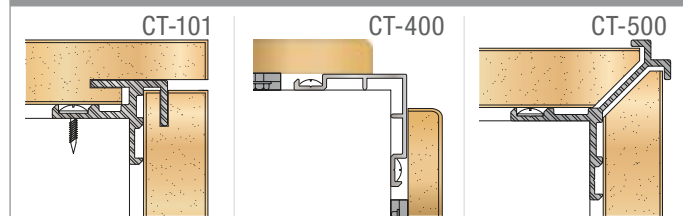

How To Spec It...		Thickness Reference	
Series	Thickness ●.....	A	1/2"
CW1-4824-C Width Height		B	5/8"
		● C	3/4"
What It Means... Concerto™ 48" x 24" panel with 3/4" thickness (Please specify desired grain direction).		D	7/8"
		E	1"
		F	1-1/8"
		G	1-1/4"
		H	1-3/8"
		I	1-1/2"
		J	1-5/8"
		K	1-3/4"
		L	1-7/8"
		M	2"
		N	2-1/8"
		O	2-1/4"
		P	2-3/8"

OPTIONAL TRIM

A variety of moldings for perimeter, reveals, ceiling, and base is available to choose from. Trim can be finished to either match or complement the wall panel.

LEED® CREDIT

Depending upon product it may contribute to LEED credits. Contact us for more information.

SPECIES + STAINS

Concerto panels are available in a variety of Veneer Species and custom stains. Please see Wood Species + Stain Catalog. Contact us for more information.

FIRE RATING

Solid Wood – Class C: ASTM E84 surface burning characteristics. Class B available with fire-rated treatment. Veneer Wood (Non-Perforated) – Class A: ASTM E84 surface burning characteristics.

DELIVERY, STORAGE & HANDLING (FOR INTERIOR APPLICATION ONLY)

Material must be stored and installed only in secured ambient environment (humidity range 25%–55%, temperature not to exceed 86°F). All windows, doors, and wet-work must be complete before installation. Handle carefully to avoid damaging.

WARRANTY

Details at armstrongceilings.com/warranty